

CIDCO
TRANSFER
PLOT

Omkara Naman



Plot No. 4, Sector-25, Ulwe, Navi Mumbai.

Key Distances:

- 10 minutes walking to proposed Kharkopar Railway Station.
- 10 minutes Drive to proposed Navi Mumbai International Air Port.
- 20 minutes Drive to Seawood-Darave, CBD Belapur Railway Stations.
- 1.5 kms to Proposed Nhava Sheva - Sewri Sealink.
- 15 minutes walking to proposed Bamandongri Railway Station.

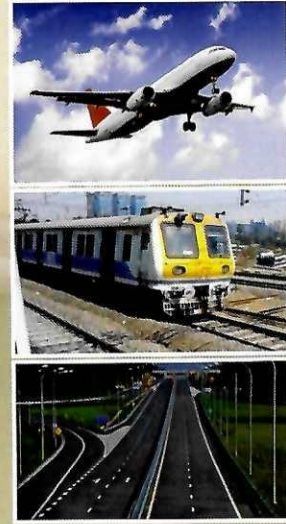

List of Amenities

- 2' x 2' Joint Free Ceramic Tiles.
- Granite Kitchen Platform with S. S. Sink
- Designer Tiles in Bath & W. C. up to door height & 4' height above kitchen Platform.
- Concealed copper wiring with modular switches.
- Concealed plumbing with reputed make fittings.
- Powder Coated aluminium frame and good branded glass.
- Main Door with Decorative shutter with brass fittings.
- Granite/ Marble frames to windows and W. C. Bath door.
- Backlite door shutter for W. C. and Bath doors.
- Oil bound distemper for internal painting.
- Acrylic Paint for external walls.



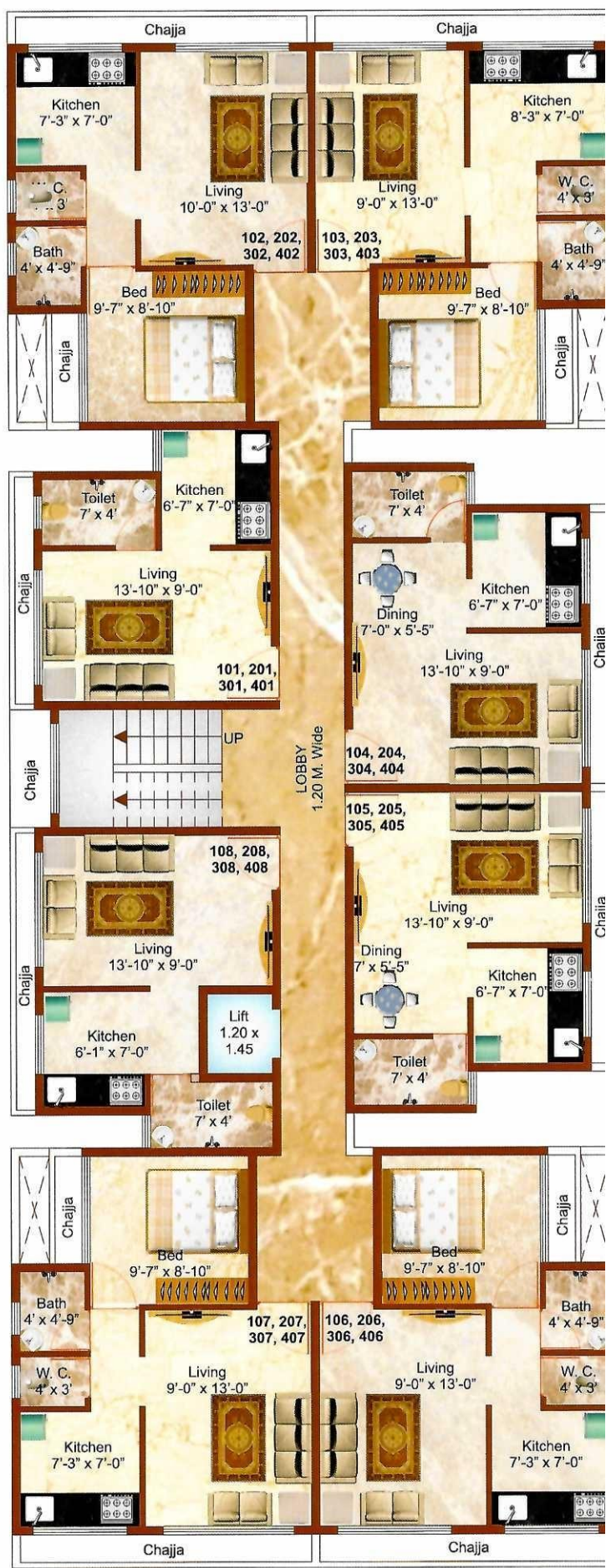
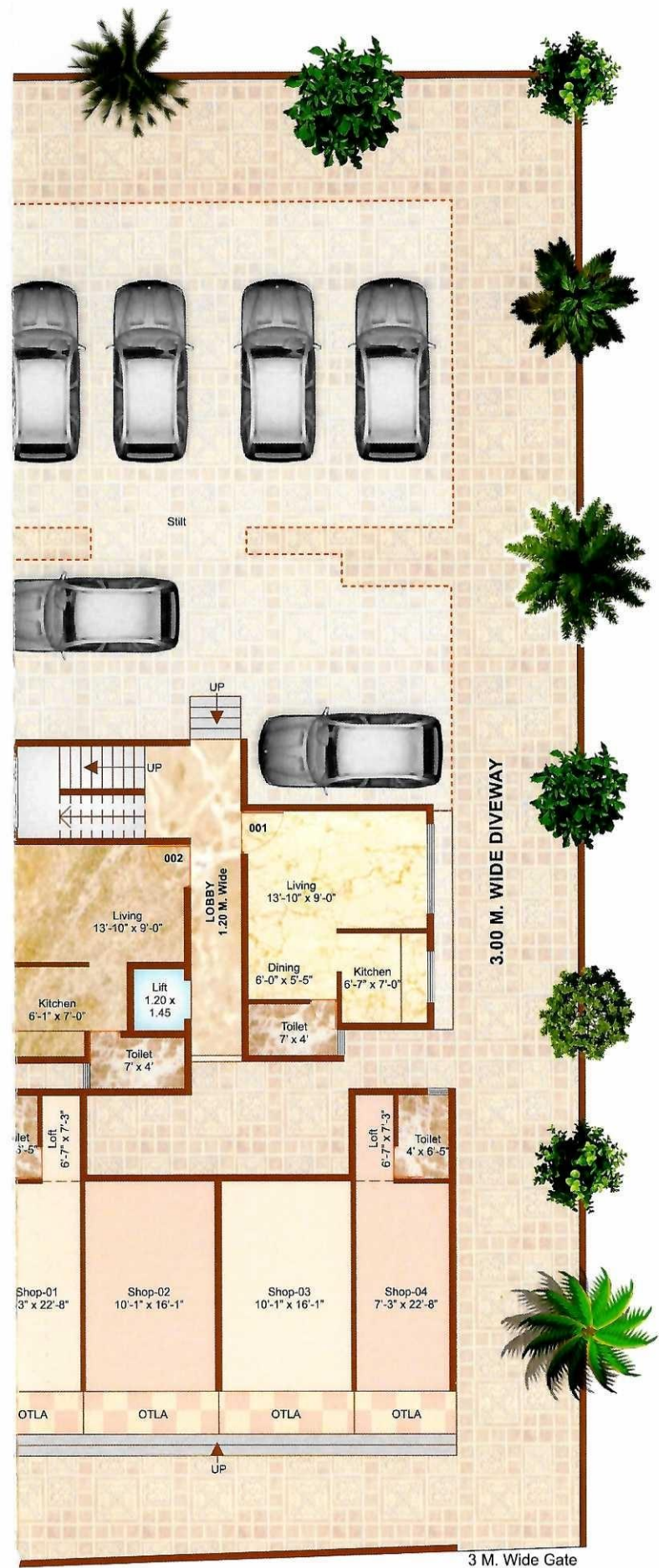

Ground Floor Plan



Typical Floor Plan (1st to 4th)

LOCATION MAP



100 M. WIDE SERVICE CORRIDOR
INTERNATIONAL AIRPORT

← **CBD BELAPUR - URAN DRONAGIRI**
PROP. AMRA MARG



Architect:
Vistaar Architects

RCC Consultant:
Adharshila Consultant



MAHA-RERA REGISTERED PROJECT
REGISTRATION NO. : P52000019570



Builders & Developers

Office No. 0901, 9th Floor, Mahavir Icon A, Plot No. 89, 90,
Sector-15, CBD-Belapur-400614.

Contact No. : 9004715222 / 8623038848